

# Pressure

'Vented Gauge' automotive 10 bar sensor



## Description

Low cost, high quality 10 bar pressure sensor with a 0-5v linear housed in a stainless steel casing with integral 3 way Packard connector.

Ideally suited to monitoring applications where measurement trace-ability is not essential.

All sensors are 'pin for pin' electrically & mechanically compatible with the Kavliko range of Magneti Marelli race specification sensors, making them suitable as replacements for existing installations.

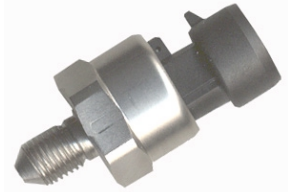

## Dimensions

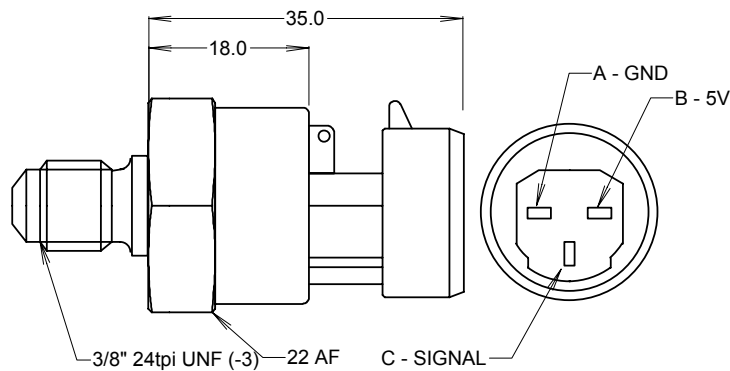

## Technical Data

### Mechanical

Thread ..... 3/8 UNF  
Accuracy ..... < +/- 0.5% 25°  
Error at temp ..... <1%  
..... -20°c > 85°c  
Cycles ..... >20 mil  
Vibration ..... 16g, RMS (20-2000Hz)  
Rating ..... IP65

### Electrical

Current ..... 7.5 mA  
Reverse voltage protection ..... yes  
Supply voltage ..... 5v  
Offset ..... 0.5v  
Full scale ..... 4.5v  
Range ..... 0-10 bar  
Output ..... Ratiometric

## Electrical connections

Connector	A	B	C
Packard	GND	5V	SIGNAL

## Ordering information

Part No.	Cable length	Description	Order Code
CS10LC	N/a	0-10 bar standard pressure sensor	
CS13	N/a	Connector kit – housing + contacts	

Competition Systems Ltd  
Hyjuniper, Long Lane  
Shaw, Berkshire,  
RG14 2TA  
England

For further details please contact

Tel: +44 (0)8707 444666  
Fax: +44 (0)8707 444888  
mail@competitionsystems.co.uk